

Neighborhood Commerce Plaza

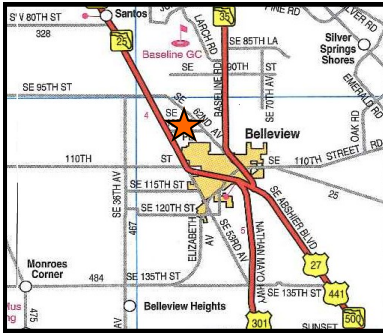

Located just north of Belleview directly east of Highway 441/301/27 at 4709 S.E. 102nd Place, Neighborhood Commerce Plaza is currently ready for move-in. Traffic counts for US 441 north of Belleview are recorded at over 30,000 cars per day. This space is conveniently located between the Belleview Commons and Belleview Regional shopping centers in the heart of Belleview's commercial area.

Anchored by Neighborhood Storage Center, the plaza provides numerous benefits including easy access from a signalized intersection, ample parking, and existing business activity. Private parking and roll-up doors are located in rear for deliveries.

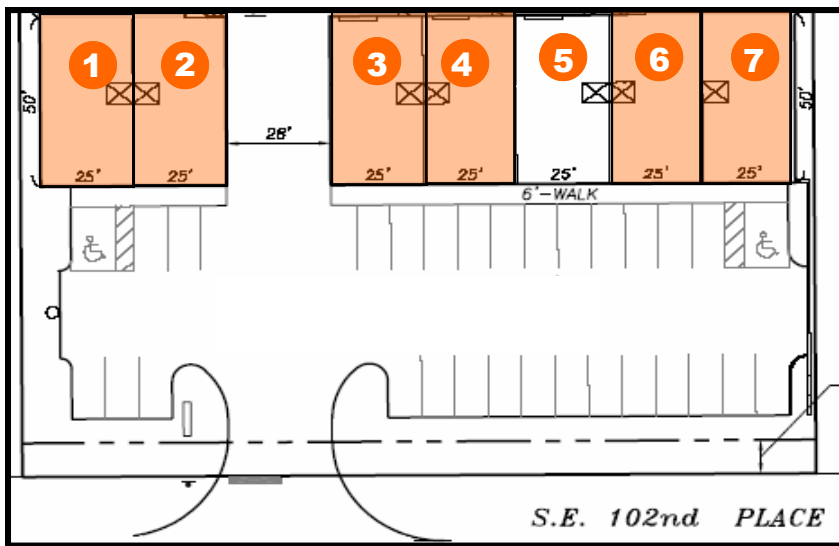

Each unit is approximately 1,250 square feet. Below is the monthly rent summary for a 1,250 square foot unit.

Estimated Monthly Rent Summary*

MONTHLY RENT	\$ 1,093.75
1/12 of Estimated Property Taxes	\$ 95.06
1/12 of Estimated Insurance	\$ 32.12
Common Area Maintenance ("CAM"):	\$ 36.50
State Sales Tax:	\$ 81.73
TOTAL MONTHLY RENT	\$ 1,339.16

*For one 1,250 square foot unit

Unit Information

Unit	Tenant
1	Nows Fashion
2	Neighborhood Storage Center
3	A.M. Gaudet & Associates
4	J & R Cabinets
5	Available
6	Customz Salon
7	True Vine Church



Demographics

	1 Mile	3 Miles	5 Miles
Population	2,880	13,939	48,036
# Households	1,258	5,844	18,993
Med. HH Income	\$36,575	\$39,736	\$38,678

101 NE 1st Avenue

Ocala, FL 34470

Todd @ IPSRealtor.com



Office: (352) 629-6101

Fax: (352) 629-7204

Cell: (352) 239-1555

All information contained herein was obtained from sources considered reliable. Neighborhood Storage Center makes no warranties or representations, expressed or implied concerning accuracy. This information is subject to misstatements of facts, errors, omissions or change in price, terms, and conditions without notice and is subject to any special conditions which may be imposed by Neighborhood Storage Center. Any person intending to rely upon this information should verify it independently.